

KREATYWNY ENERGY POLSKA

Base station adds power module



Overview

Power capacity redundancy means designing a base station power system with an output capacity significantly higher than the maximum expected load. It also includes backup power modules to ensure stable operation if a primary module fails or load demand spikes. Tokyo, Janu- NEC Corporation (NEC; TSE: 6701) today announced the development of a high-efficiency, compact Power Amplifier Module (PAM) for the sub-6GHz band, designed for integration into 5G base station Radio Units (RUs). The table below highlights this dramatic increase: Operators now face several challenges: Higher RF power amplifiers and complex physical-layer processing increase energy. With 5G base station power consumption increasing significantly and service scenarios constantly expanding, redundant power capacity is no longer optional—it is a key factor determining whether a base station can operate continuously and reliably.

Base station adds power module



The Critical Role of Redundant Power Design in 5G Base Stations

Power capacity redundancy means designing a base station power system with an output capacity significantly higher than the maximum expected load. It also includes backup power ...

Mitsubishi Electric Achieves World's First Performance Verification of

Going forward, Mitsubishi Electric will continue research and development aimed at the practical application of the PAM in 5G-Advanced base stations. Technical details will be presented at ...



NEC Develops Energy-Efficient Sub-6 GHz Power Amplifier for 5G ...

NEC Corporation has developed a high-efficiency, compact Power Amplifier Module (PAM) for the sub-6 GHz band, designed for integration into 5G base station Radio Units (RUs). PAMs ...

5G Base Station Power Upgrade: Custom Rectifier Module Solutions

...

Upgrade 5G base station power in outdoor, indoor, and shared cabinets with custom rectifier module solutions for efficient, scalable, and reliable performance.



Mitsubishi... , MITSUBISHI ELECTRIC US, Inc. Semiconductors and ...

Going forward, Mitsubishi Electric will continue research and development aimed at the practical application of the PAM in 5G-Advanced base stations. Technical details will be presented at ...

NEC Develops High-Efficiency, Compact Power Amplifier Module for ...

...

NEC plans to incorporate this PAM into new RUs scheduled for release in the first half of fiscal year 2026 (*2) and also envisions a global deployment of the PAM as a standalone product, ...

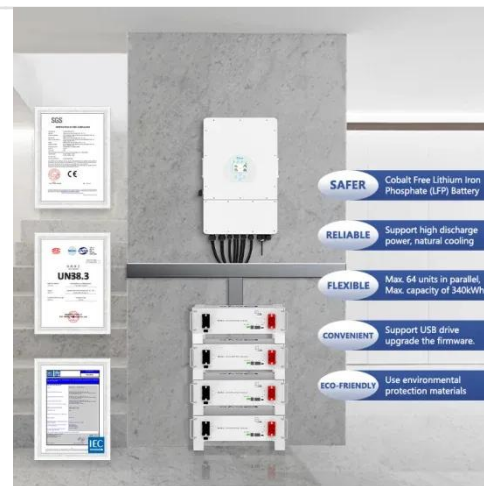

Powering 5G Infrastructure with Power Modules , RECOM

Discover power module solutions for 5G infrastructure delivering high power density, efficiency, and reliability for

base stations and small cell deployments.



Mitsubishi Electric to Ship Samples of GaN Power Amplifier Module for

Power amplifier modules help reduce the power consumption of 5G mMIMO base stations. Providing high-speed, large-capacity communications, 5G mobile networks are becoming ...



NEC Develops Compact PAM for 5G Base Station Radio Units

TOKYO - NEC Corporation today announced the development of a high-efficiency, compact Power Amplifier Module (PAM) for the sub-6GHz band, designed for integration into 5G ...



Contact Us

For catalog requests, pricing, or partnerships, please visit:
<https://www.kreatywny-dom.pl>

